



If you want more...
如果你想了解更多...



... than just a bakery
...不仅仅是一间面包店



Member of Kolb Group
高比团队成员



QUALITY AT UNBEATABLE PRICES

AT ALL SPEEDS



Gecon offers Swiss know-how for a very competitive price
 捷康以竞争价格为您提供瑞士的专门技术

Our latest products are the Atoll Speed 300 and Atoll Speed 400
 我们最新的产品—微波炉300和微波炉 400

Atoll Speed – most suitable for

- convenience stores
- hotels & restaurants
- coffeeshops

微波炉—最适合

- 便利店
- 酒店&餐馆
- 咖啡厅

Atoll Speed 400 is also available with steam. The steam will improve your baking result
 微波炉400还可以利用蒸汽. 蒸汽将会改善您的烘焙效果

With Atoll Speed you heat up every kind of food, bakery product and beverages!!!
 有了微波炉, 您可以加热任何食物, 面包产品和饮料!

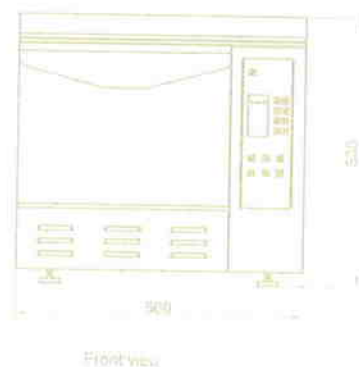

Atoll Speed 微波炉

Atoll Speed is so powerful that heating up just takes a few seconds. Thus you can serve your customer faster

微波炉高速有力，所以加热只需很短时间，因此您可以更快地服务客户

Thanks to our experienced engineers we could lower energy consumption significantly
由于我们经验丰富的工程师，我们可以显著降低能源的消耗

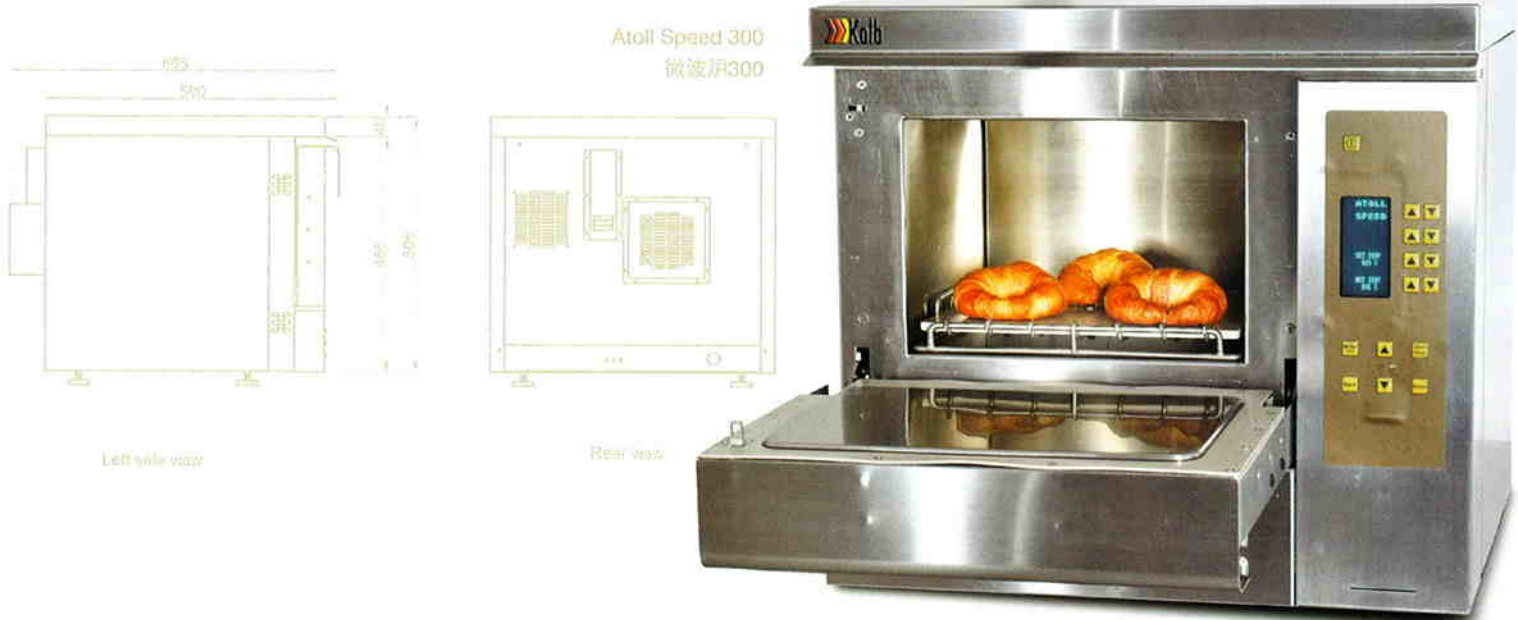

European components ensure the sustainability
of our products

欧洲的体系确保了我们产品的持续性

As a consequence Atoll Speed fulfills the highest
quality standards

因此微波炉达到最高的质量标准

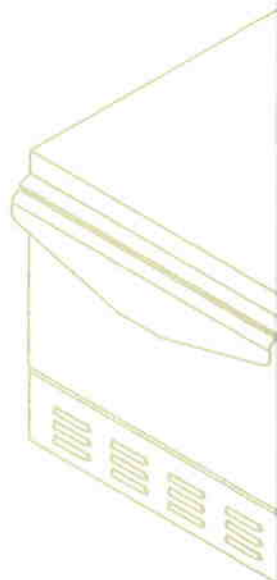
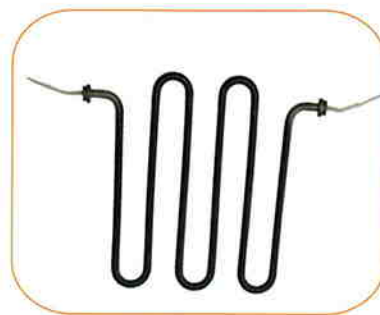

Atoll Speed Features

微波炉的特点

- 10 different speed settings
10种不同的速度设置
- Heat up any food & beverage products in a few seconds
只需很短时间就能加热任何食品饮料产品
- Air circulation with top and bottom heat
顶部和底部加热的时候有空气流通
- Combination of convection oven and microwave
烤炉和微波炉的结合体
- Optional water tank for ideal baking results
理想烘焙效果的可选水箱
- Easy handling
容易操作
- Low energy consumption
能量消耗低
- Comprehensive after sales service
售后服务周到

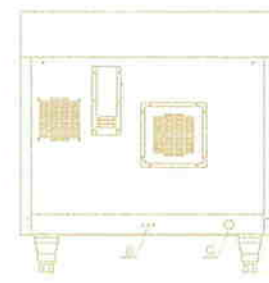
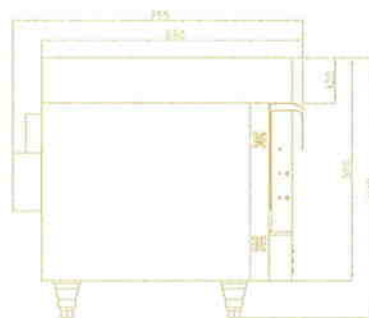
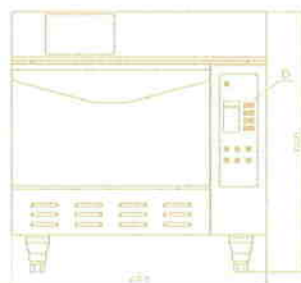
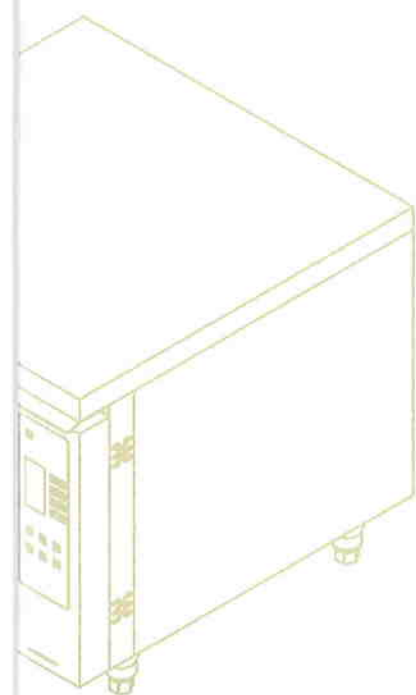

Atoll Speed 400 with steam
微波炉400 有蒸汽



Technical Details

技术信息

With removable water tank

带可移动的蒸汽水箱



	Atoll SPEED 300 微波炉300	Atoll Speed 400 without steam 微波炉400 (没有蒸汽)	Atoll Speed 400 with steam 微波炉400 (有蒸汽)
Model-Nr. 型号	GC-2040	GC-2050	GC-2041
Outside dimension W/D/H in mm 外部尺寸 长/宽/高 (厘米)	650 x 665 x 530	660 x 765 x 600	660 x 765 x 680
Baking chamber dimension W/D/H in mm 烘烤室尺寸 长/宽/高 (厘米)	300 x 270 x 190	400 x 370 x 190	400 x 370 x 190
Voltage 电压	400V/ 50 Hz/ 3~	400V/ 50 Hz/ 3~	400V/ 50 Hz/ 3~
Current 电流	14.3 A	15.2 A	15.2 A
Weight in kg 重量(千克)	67 kg	92 kg	98 kg

The customer service team

The customer service team arranges installation, commissioning and after sales service. We guarantee service within 5 hours in Guangdong Province, Shanghai and Peking. For the other provinces, we provide service within 24 hours after receiving your call.

捷康客户服务部安排安装、调试及售后服务。在接到您的电话后，我们保证广东省、北京市和上海市内5小时的服务，其他省份我们将会24小时内为您服务。



Offices in China and Hong Kong

Huizhou Office

惠州公司
Gecon Ltd.

Fenghua Dasha, Wu Feng Road,
YuanZhou Town,
Boluo County, Huizhou City,
Guangdong Province,
China, PC: 516123
中国广东省惠州市博罗县
园洲镇五丰路丰华大厦
邮编: 516123

Hong Kong Office

香港办事处
Kolb HK Ltd.

Unit 201, Block B,
Hoi Luen Industrial Centre,
55 Hoi Yuen Road,
Kwun Tong, Kowloon,
Hong Kong
香港九龙官塘开源道55号
开联工业中心B座201室

Beijing Office

北京办事处
Gecon Ltd.

Room 1502, Jiarun Garden
Building A,
No 19 Guang Shun Nan Avenue,
Chaoyang District, Beijing,
China, PC: 100028
北京市朝阳区望京广顺南大街19号
嘉润花园A座1502室
邮编: 10028

Shanghai Office

上海办事处
Gecon Ltd.

Room 1010, Bai Di Yi Shan
Building A,
No. 2006 Building,
Zhongshan West Road,
Xu Hui District, Shanghai,
China, PC: 200235
上海市徐汇区中山西路2006号
百第宜山大楼A楼1010室
邮编: 200235

Contact Person/联系人:
Ms Benny Chen/陈小姐
Tel: +86 752 6111 208
Fax: +86 752 6111 201
Mail: sales@gecon-cn.com

Contact Person/联系人:
Ms Josephine Wong/黄小姐
Tel: +852 2516 6093
Fax: +852 2516 6518
Mail: jwong@kolb-hk.com

Contact Person/联系人:
Ms Cathy Luo/罗小姐
Tel: +86 10 6477 6808
Fax: +86 10 6477 6148
Mail: cathy@gecon-cn.com

Contact Person/联系人:
Ms Rose Zhang/张小姐
Tel: +86 21 6115 2081
Fax: +86 21 6115 2095
Mail: shanghai@gecon-cn.com